



SCALE- 1: 900

22°36'10.6236"N  
88°20'55.316"E

22°36'12.8448"N  
88°20'57.296"E

22°36'9.0072"N  
88°20'59.467"E

22°36'11.1456"N  
88°21'0.886"E

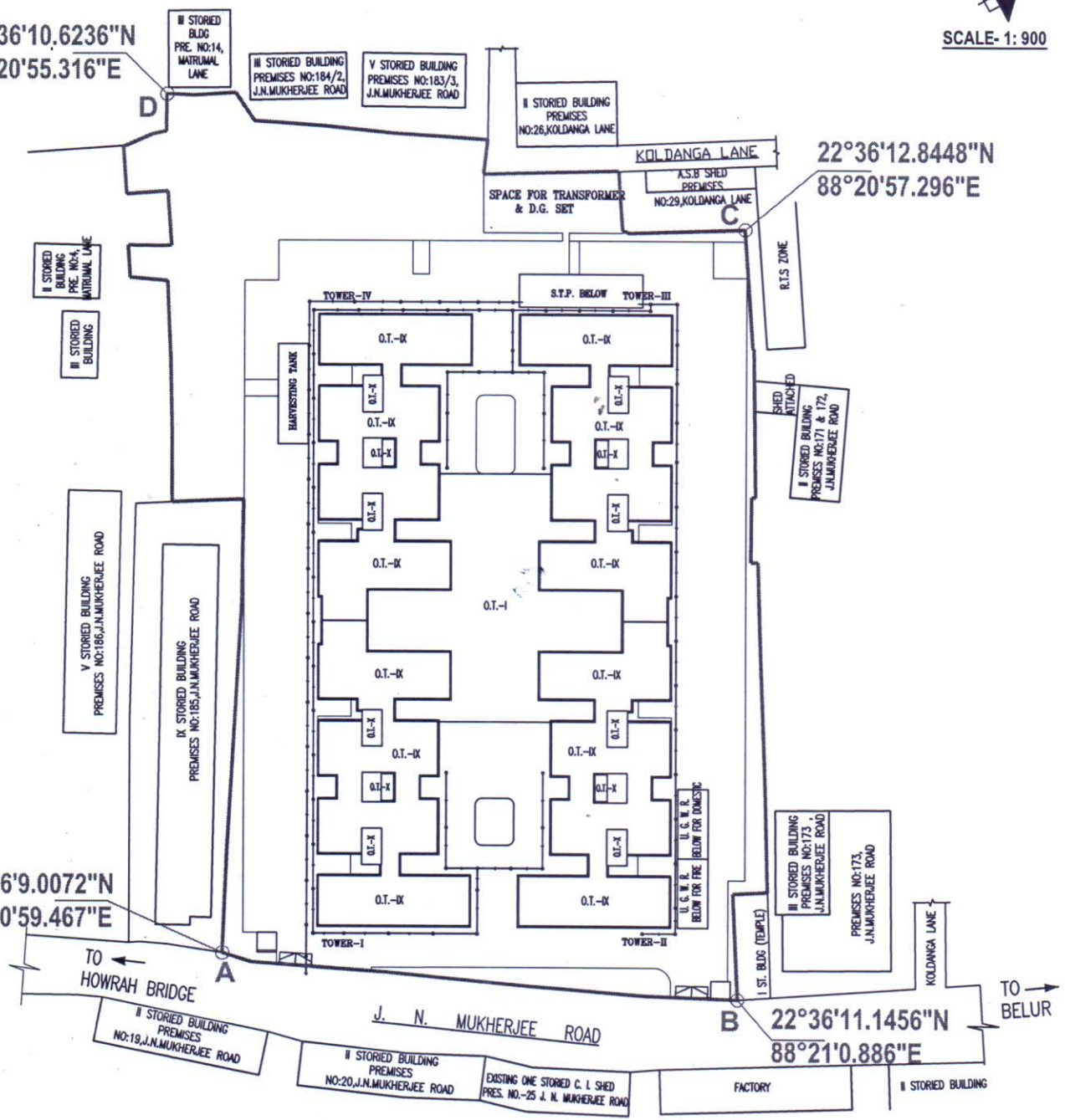

For RAGA PROJECTS LLP  
*Utkarsh Choudhary*  
 Partner

PREMISES NO.- 184, J. N. MUKHERJEE ROAD,  
 WARD NO-04, P.S- MALIPANCHGHARA, DIST.  
 HOWRAH, HOWRAH- 711106, UNDER HOWRAH  
 MUNICIPAL CORPORATION.